

AICOK

VEGETABLE MACHINE INSTRUCTION MANUAL

VM9008-GS

VEGETABLE MACHINE
INSTRUCTION MANUAL

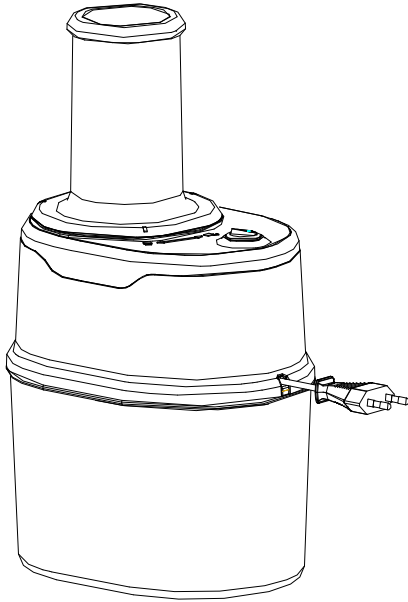

Model: VM9008-GS

Read this booklet thoroughly before using and save it for future reference

IMPORTANT SAFEGUARDS

When using the electrical appliance, the below basic safety precautions should be followed:

1. Carefully read the instructions before using your appliance: a non-conforming use in instructions will absolve the manufacturer from any liability.
2. It should supervise children to ensure they do not play with the appliance.
3. It is designed to operate with alternating current. We ask you before first use to verify that the mains voltage corresponds to that indicated on the rating plate of the unit.
4. Do not place or use this product on a hot plate or near a flame (gas stove).
5. To prevent accidents and damage to the equipment, always keep hands and utensils away from the blades and moving cones.
6. Do not operate the unit for more than 1 minute continuously.
7. This appliance can be used by children aged from 8 years and above and persons with reduced physical, sensory or mental capabilities or lack of experience and knowledge if they have been given supervision or instruction concerning use of the appliance in a safe way and understand the hazards involved. Children shall not play with the appliance. Cleaning and user maintenance shall not be made by children unless they are older than 8 and supervised.
8. Do not chop meat.
9. Never remove the cones before it stops.
10. Never feed food by hand, always uses the pusher.
11. Do not use the product for too hearty foods (sugar, meat).
12. Only use accessories supplied with the appliance.
13. The appliance must be unplugged:
 - If there is an abnormality in operation,
 - Before cleaning or maintenance ,

- After each use.
- 14. Do not unplug by pulling on cord.
- 15. An appliance should not be used:
 - If it is dropped,
 - If the cones are damaged or incomplete.
- 16. Always disconnect the unit from the power supply if it is left unattended and before the introduction or removal of blade cone.
- 17. If the power cord is damaged, it must be replaced by the manufacturer, its service agent or a similarly qualified person in order to avoid any danger service.
- 18. Do not use parts other than those provided by the centers authorized after-sales service.
- 19. The product has been designed for home use. Warranty and product liability does not apply in the case of professional use, inappropriate use or failure to observe the instruction manual.
- 20. This appliance is intended to be used in household and similar applications such as:
 - Staff kitchen areas in shops, offices and other working environments;
 - Farm houses;
 - By clients in hotels, motels and other residential type environments;
 - Bed and breakfast type environments.

KNOW YOUR VEGETABLE MACHINE

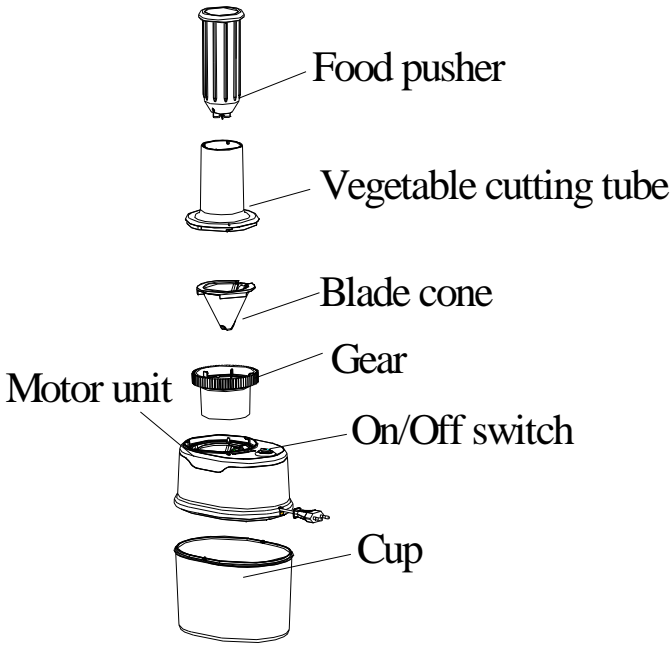

BEFORE FIRST USE

Unpack the appliance and remove all the detachable components for cleaning them with running water. Never immerse the motor unit in the water for cleaning.

OPERATION

1. Put the motor unit on the cup, then install the gear, blade cone, vegetable cutting tube and food pusher in sequence.

NOTE: The appliance will not work unless the motor unit is well assembled on the cup.

2. Cut the head of the food (e.g. Carrot, radish, cucumber, sweet potato, cucurbita pepo);

NOTE: The food should be long and 30mm-60mm in diameter.

3. Fix the carrot on the bottom of food pusher (see photo as below), ensure the carrot shall be fixed well and without looseness ;



4. Put carrot and food pusher together into vegetable cutting tube;



5. Plug in the appliance, then press the switch to "1" position;

6. Press down the food pusher with consistent force;

NOTE: The unit has been equipped with a chipping blade and there are optional blades including stripping blade and circle blade.

Chipping blade

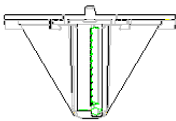

Stripping blade

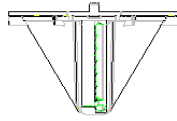

Optional

7. The processed carrot will fall into the cup;

8. When the cup is full of food, remove the cup and the appliance will stop working automatically.

NOTE: The appliance must be cooled down to room temperature before after being operated for 3 cycles continuously.

9. After finish operation, press the switch to "O" position, unplug the power source.
- 10.If you want the unit working without food, you should press down the food pusher, the unit will work normally.

CLEANING AND MAINTENANCE

1. Unplug the power cord before cleaning.
2. Disassemble all the components such as vegetable cutting tube, blade cone, food pusher and gear. Please clean all the accessories after each use.

Caution: ①Ensure that the motor unit is unplugged when disassembling.

②The blade is sharp, please handle carefully when cleaning.

③Please turning vegetable cutting tube clockwise to take it out.

3. Wipe the outside surface of the motor unit with a damp cloth, then drying thoroughly.

Note: Never immerse the motor unit in the water for cleaning.

4. When not in use, put the motor unit into the cup for storage.

WARRANTY

The warranty period of the whole unit and the blade are one year.

ENVIRONMENT FRIENDLY DISPOSAL



You can help protect the environment!
Please remember to respect the local regulations: hand in the non-working electrical equipments to an appropriate waste disposal center.



Shenzhen Impression E-commerce Co.,Ltd
Facebook Page: <https://www.facebook.com/aicoks/>
Website: www.aicok.cc
Add: Booth No.3H012, Trading Plaza, No.5, Huanan city,
Pinghu Street, Longgang District, Shenzhen,China

Made In China